

Notes
 DO NOT SCALE FROM THIS DRAWING
 Work to figured dimensions only
 Site dimensions are to be checked before work is started
 If in doubt ask
 © Nye Saunders

This drawing is prepared for Local Authority approval on behalf of the applicant named below and/or named on the planning or building regulation application forms and may be used for no other purpose. The copyright of the drawing and designs remains the architect's. All copies are for information only about the application; they may be used for no other purpose without the express written permission of Nye Saunders

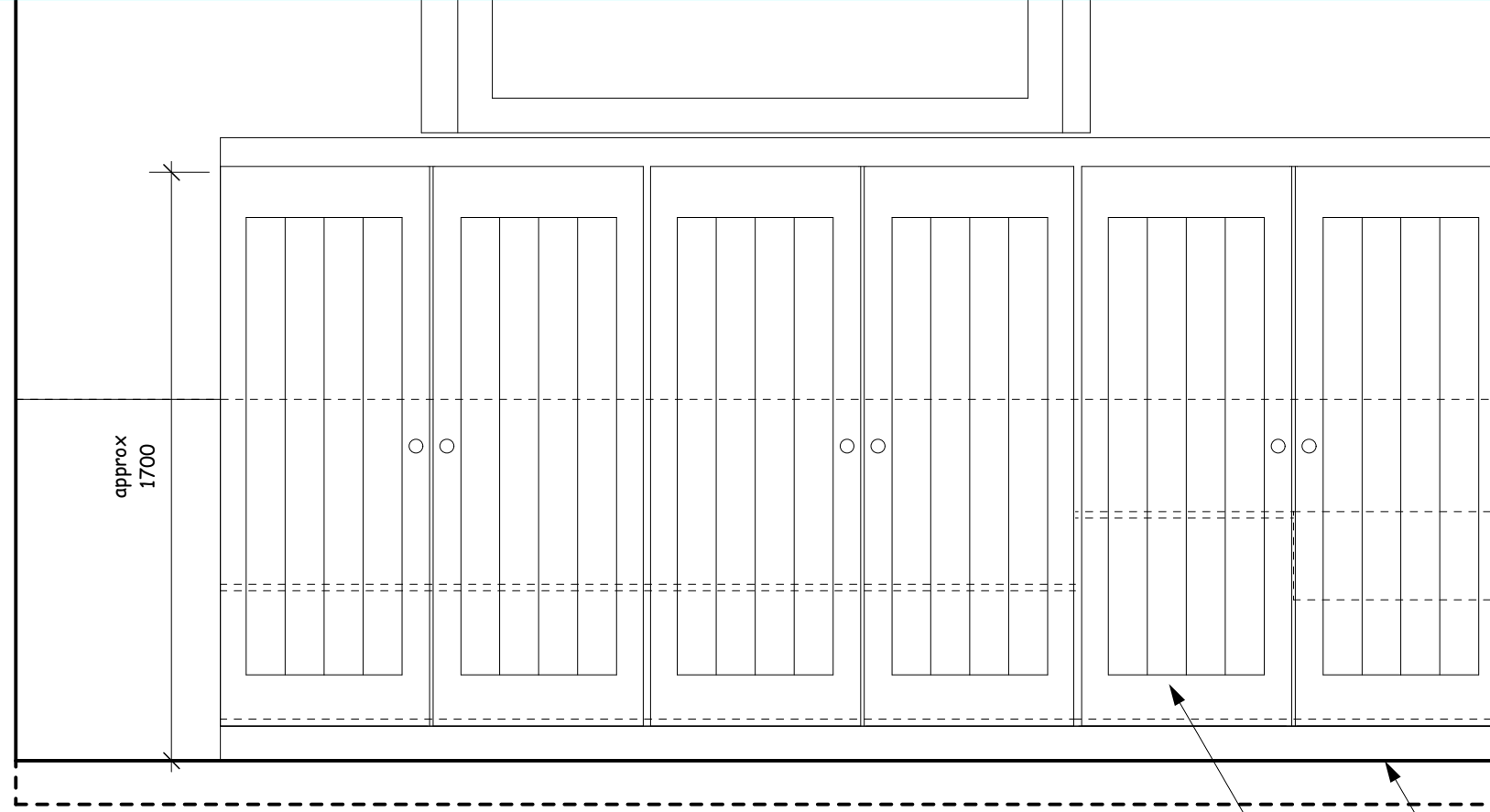

new raised floor level

new built in cupboards in oak with perhaps moulded panels reclaimed from salvaged pews and / or pulpit

tall cupboards with adjustable shelving

built in Belfast ceramic sink drained to ground

Elevation view of south transept cupboards

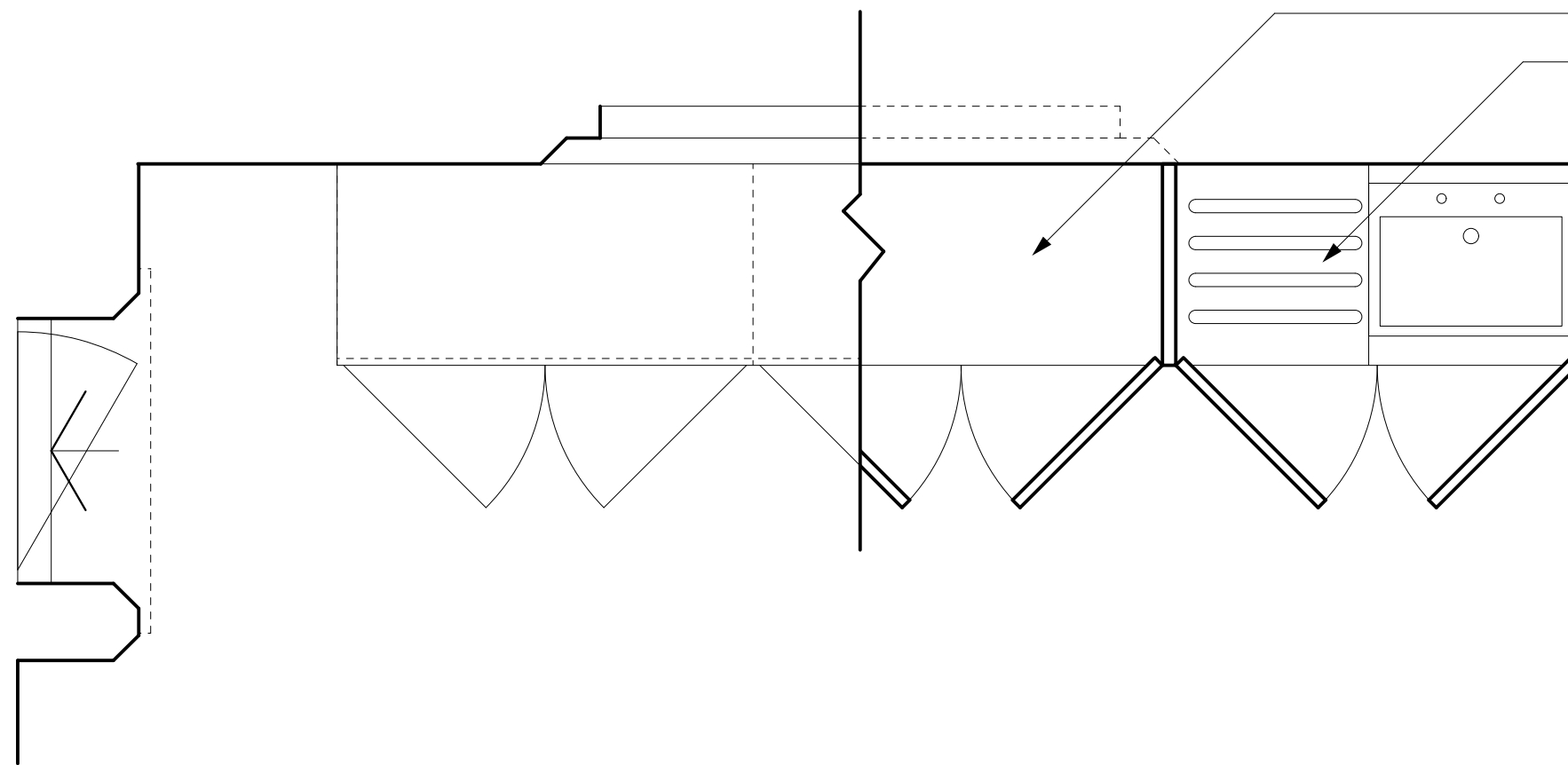

Plan view of south transept cupboards

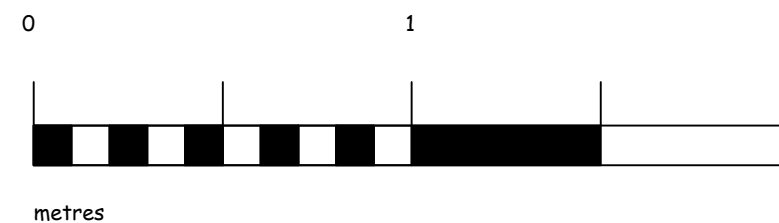

ref.	revision	date
scheme		
All Saints Witley		
title		
South transept Flower arranger's cupboards		
job ref.	drawg. no.	revision
0533	33	-
scale	date	
1 : 20 at A3	May 07	
drawn	checked	drawn
M. Staff	-	-

Nye Saunders
 Chartered Architects
 3 Church Street
 Godalming Surrey GU7 1EQ
 Telephone Guildford (01483) 418600
 Facsimile Guildford (01483) 418655